

# TUBE END MILLING UNIT

Made in Germany

- High cutting capacity
- Quick and secure clamping
- Rugged and compact type of construction
- Easy handling



**MF4-R**

## Field of application

The unit serves to machine and prepare welding edges on tubes, branches and headers. On steambloc boilers it is used for machining tube walls and cutting out welds. Having a low weight the unit is of very rugged design. Operated by one man only, it is well suited for use in the workshop and on site. Due to its extremely compact type of construction it can be readily used in confined space. Its high working speed and quick readiness allow economical manufacturing.

# TECHNICAL DATA

## Working Range:

Tube outside diameter:	min. 48,3 mm max. 88,9 mm
Tube wall thickness:	max. 10,0 mm
Spindle stroke:	15,0 mm
Form of weld:	I, V or special form

## Compressed air gear motor:

Power:	740 W at 6 bar
Air consumption:	0,96 m <sup>3</sup> /min
Compressed air connection:	R 1/4"
Feed:	manual
Weight:	5,3 kg

## Electric geared motor:

Power consumption / connection voltage: 1200 W with 230V - 50Hz  
 ~(singlephase - alternating current) II - all-insulated  
 Protective class

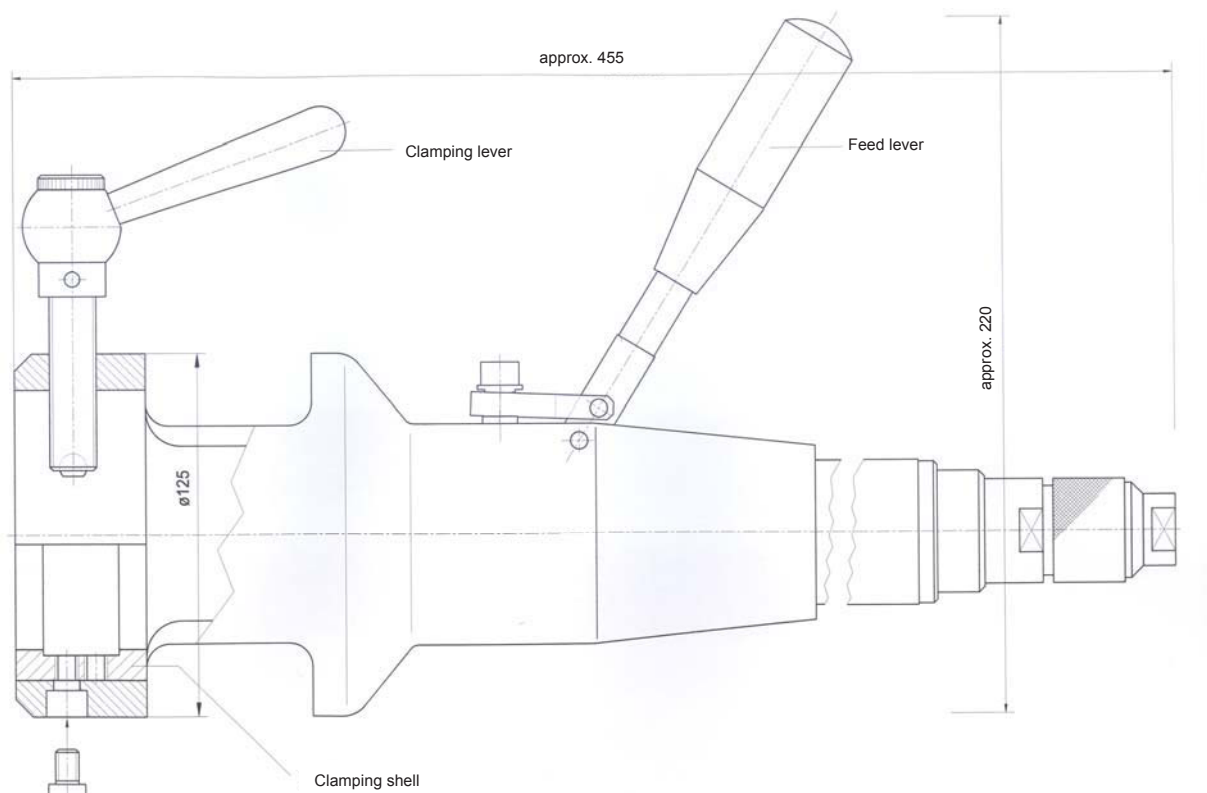

# BLADE & TOOL TIP HOLDER

with adjustable cutting tools for tube end milling unit Type **MF4-R**



091501105  
HSS  
cutting tool tip 0°



091501028  
HSS  
cutting tool tip 30°



091501106  
HSS  
cutting tool tip 0° (TIN)



091501108  
HSS  
cutting tool tip 30° (TIN)

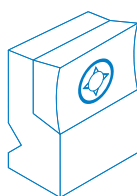

091502138  
cutting tool tip holder 0°

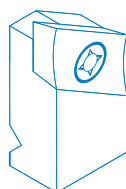

091502136  
cutting tool tip holder 30°

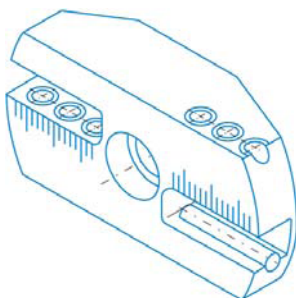

091502118  
adjustable blade holder size 1  
Working range: di 25 - do 88,9 mm



091502141  
HSS-blade 0°



091502140  
HSS-blade 30°



091502162  
10° - internal



091502163  
8° - internal



091502135  
10° - internal



091502160  
DIN 2559-4



091502148  
DIN 2559-3



091502154  
DBS 34-R3



091502159  
DBS 34-R5

Various special blades on request!